

Assembly Instructions for cabinets: S60SZ1E/442

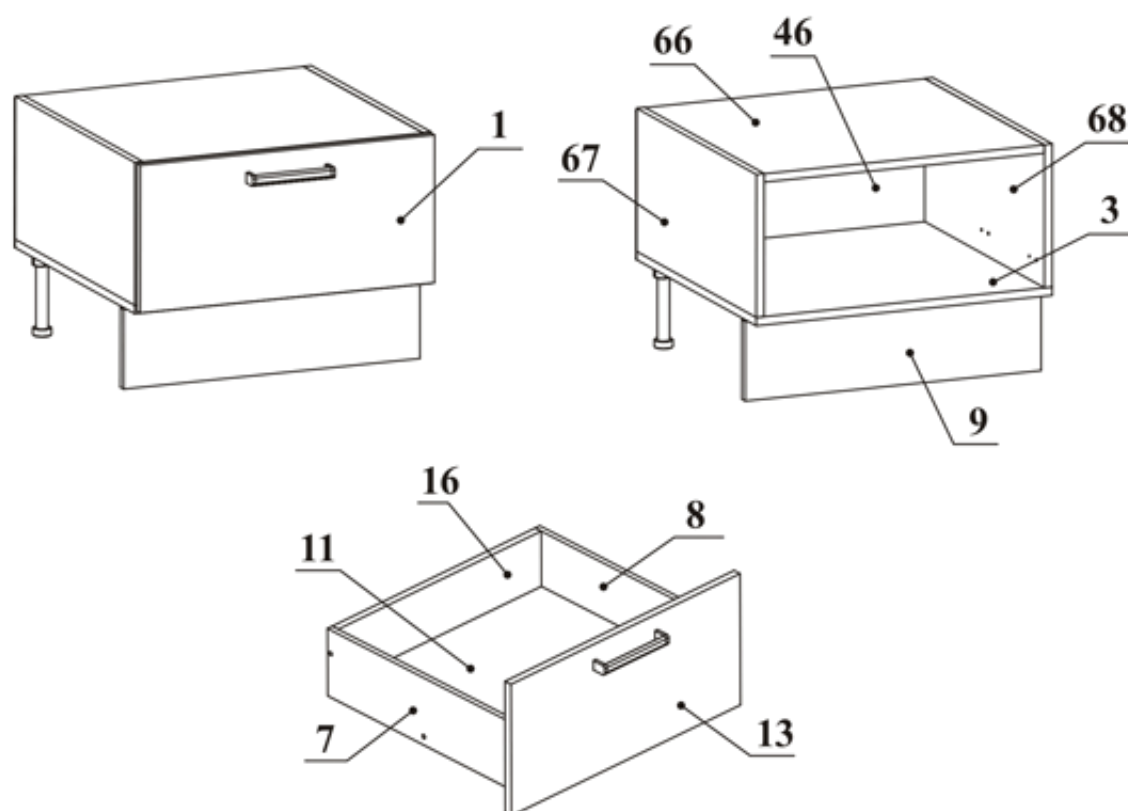

Check all the items are in your box according to the list on this manual. If you are missing anything, please check all other boxes first and then send us an email with a list of the parts you need.

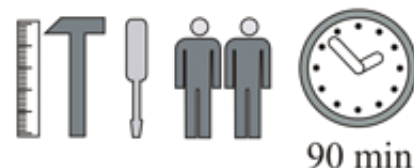

90 min

A1 X18 	B4 X6 	B5 X4 	B7 X2 	G5 X6 	UP6 X4 
H7 X1 	D14 X4 	B11 X10 	G4 X10 	D10 X24 	G2 X1 
B3 X18 	I12 X4 	I14 X2 	D30 X4 	ZN X1 	D26 X2 

S60SZ1E/442

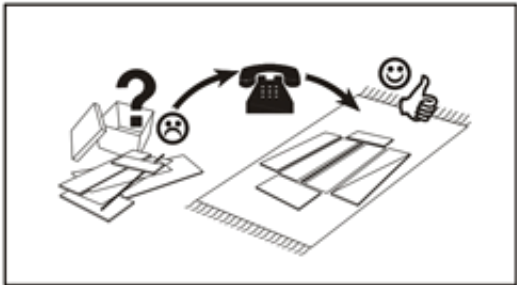

Check all the items are in your box according to the list on this manual. If you are missing anything, please check all other boxes first and then send us an email with a list of the parts you need.

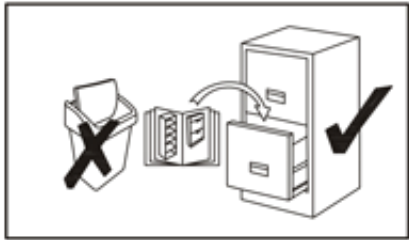

Keep your product assembly manual in a safe place until your kitchen is finished.

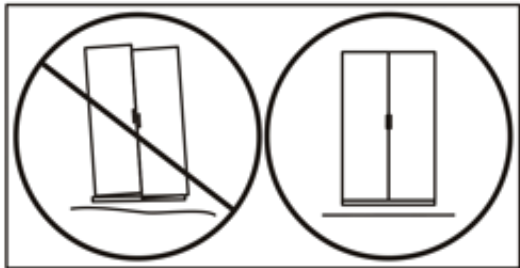

Be sure to assemble your cabinets on a flat surface and keep them straight and square.

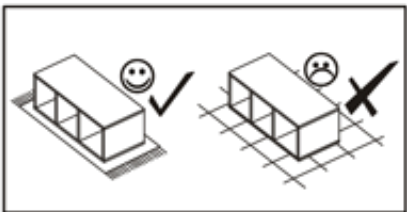
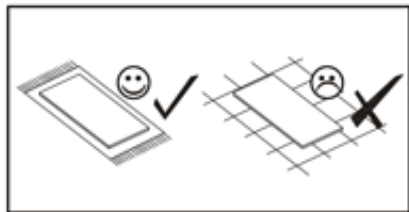

Assemble your cabinets on a rug or a surface that will not scratch or damage them.

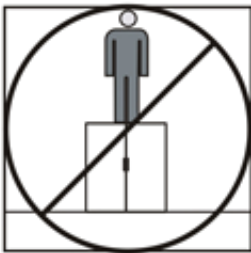
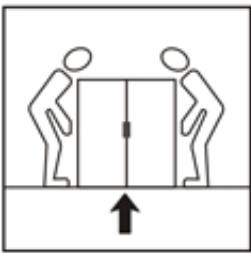

Do not push cabinets into place. Get someone to help you lift the cabinets into place, or you could risk damaging the feet.
Do not stand on the cabinets.

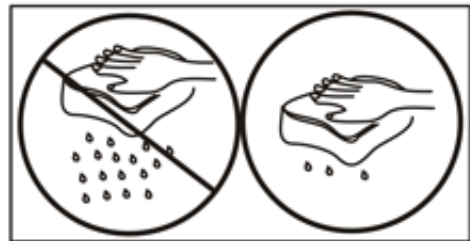

Once protective film on thermal wrap doors is removed, do not clean for 7 days. This allows the surface to harden. Only clean the cabinets with a small amount of warm water or non harsh chemicals.

S60SZ1E/442

1

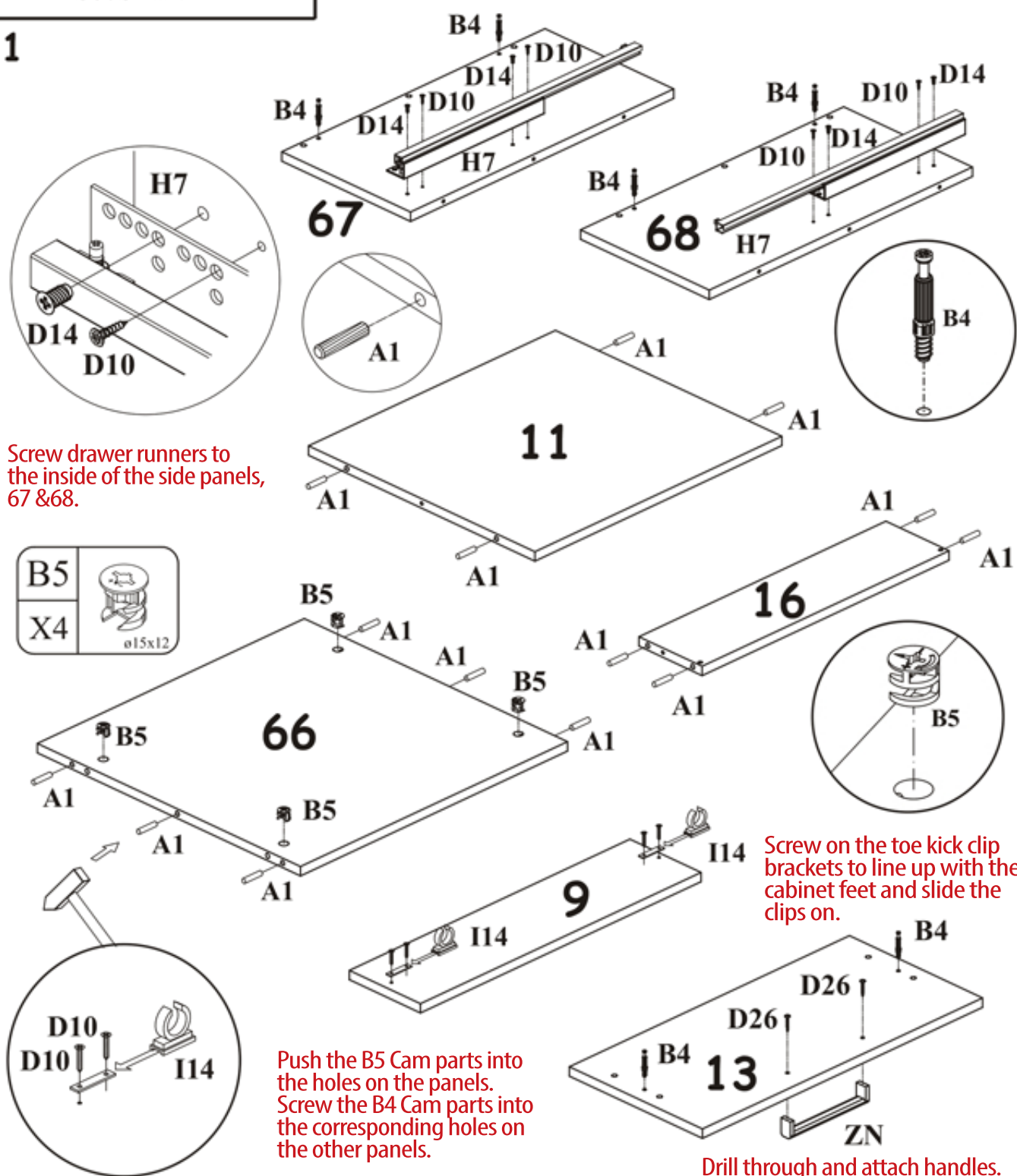

2

Push the B7 Cam parts into the holes on the drawer side panels, 7 & 8.

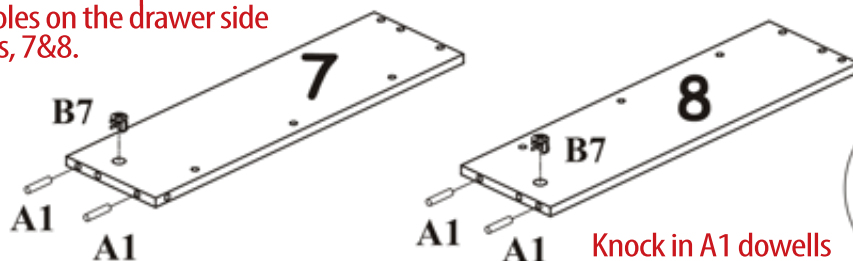

Knock in A1 dowells

S60SZ1E/442

3

Push sides into the base panel so that the B4 Cam parts slide into the corresponding holes. Now tighten B5 Cam part to lock the Cam joint together.

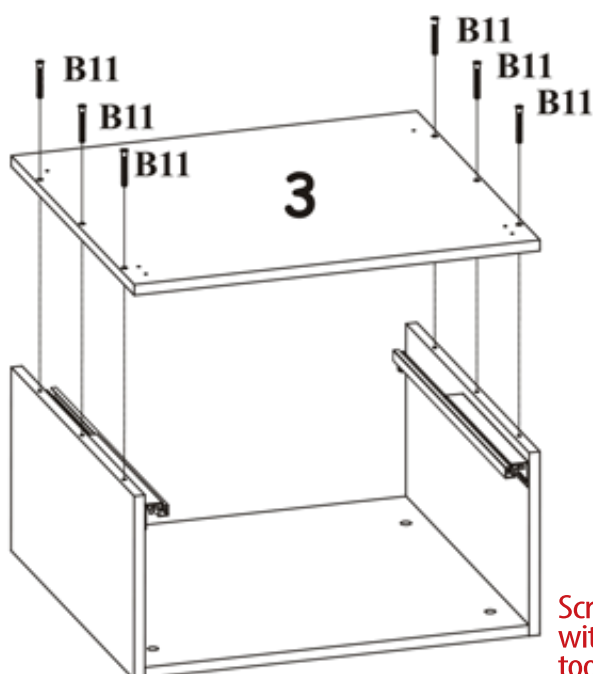
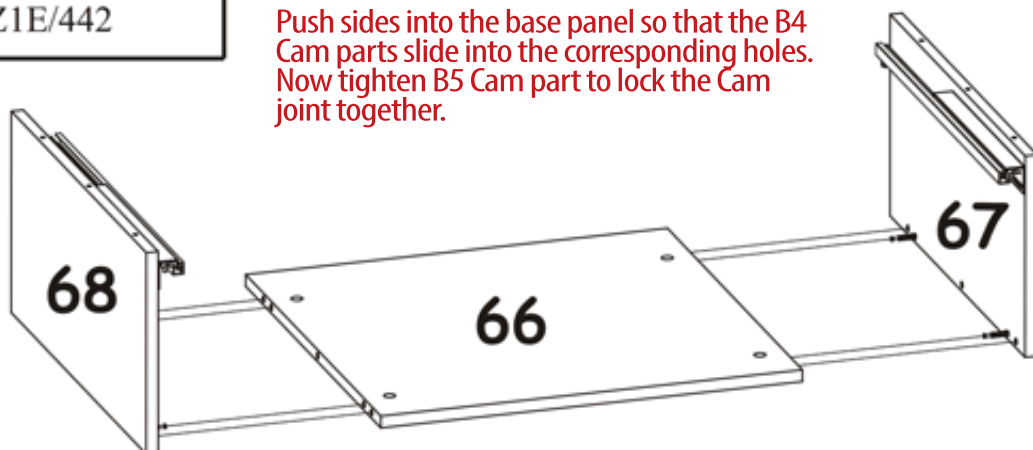

Screw top panel (3) on to frame with B11 screws and allen key tool.

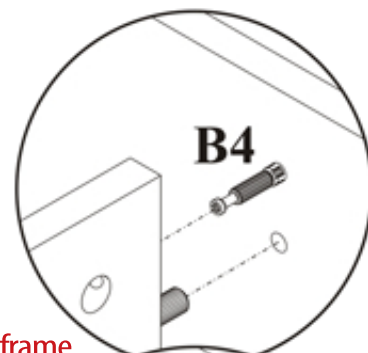
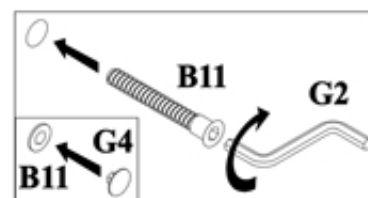

Nail on back panel, making sure it is square.

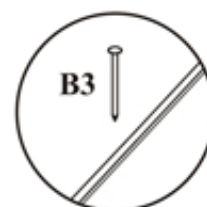

4

$X=Y$ 90°

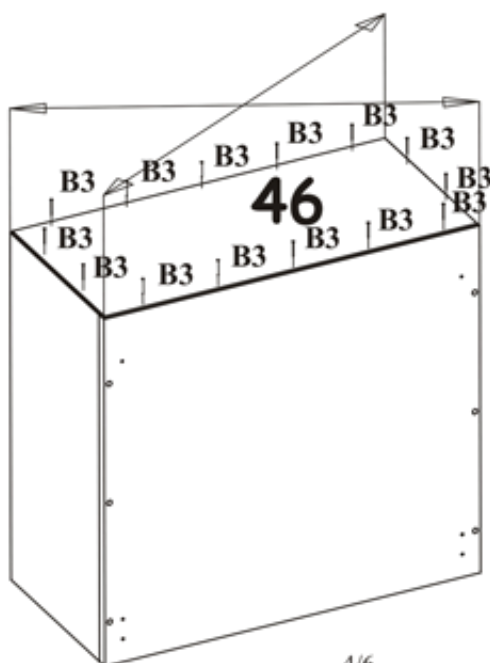

S60SZ1E/442

Turn the cabinet upside down and screw feet to base.

5

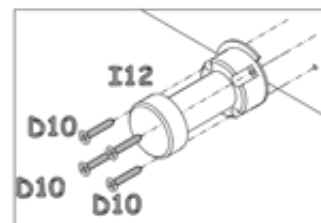
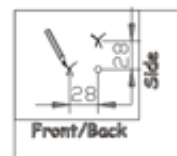
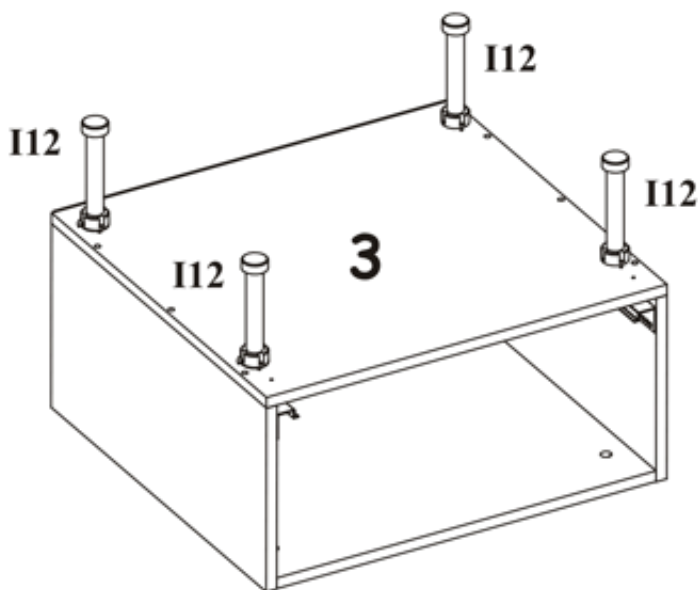

6

Screw together drawer frame with B11 screws and allen key tool.

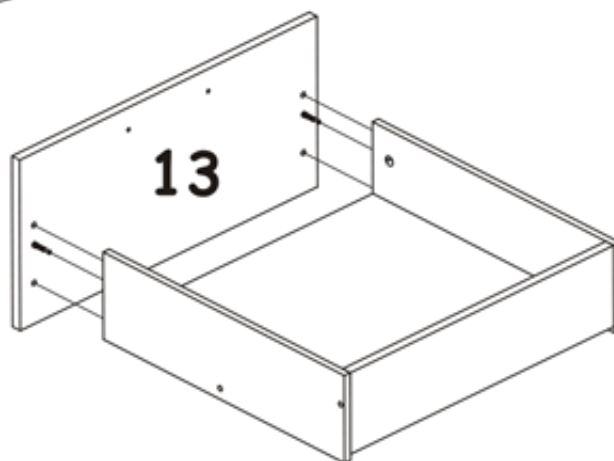
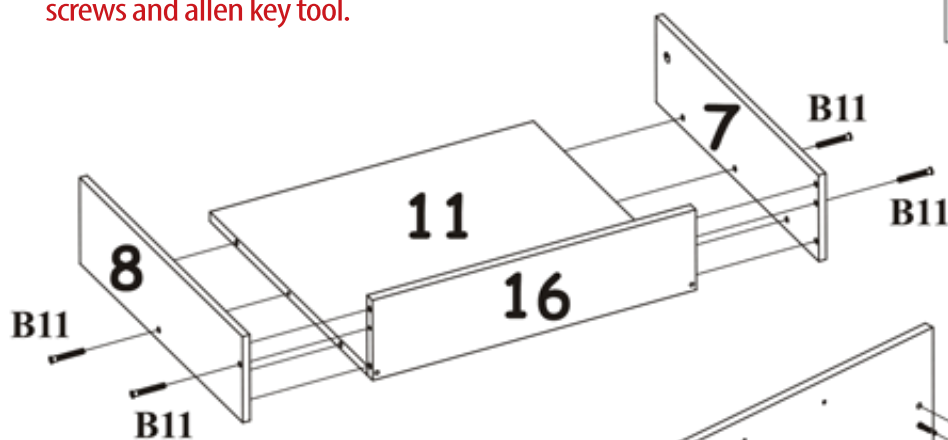
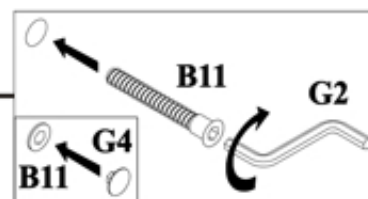

Push the drawer front on so that the B4 Cam parts slide into the corresponding holes on the other panels. Now tighten B5 Cam part to lock the Cam joint together.

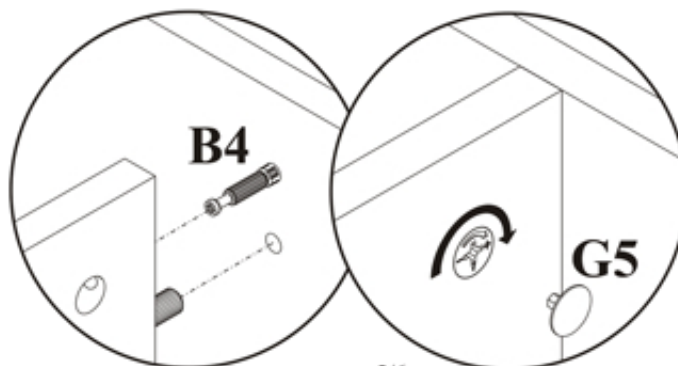

S60SZ1E/442

- 7** Lower the drawers into place on the drawer runners. This is best done by tilting the front of the drawer up as you place it into the runners. Make sure the upwards pointing pin on the drawer runner sits up in the hole on the underside of the drawer edge.

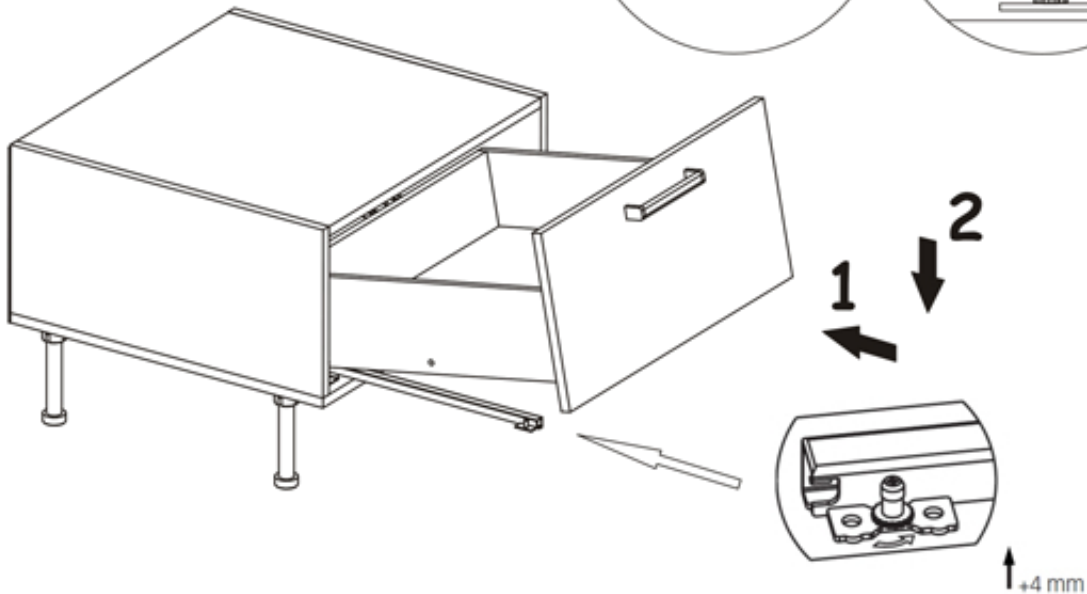
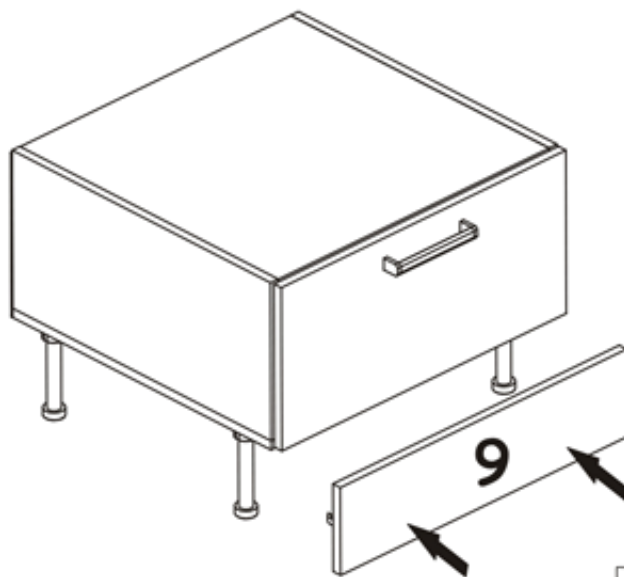
**8**

Follow instructions for fitting toe kicks. Screw on the toe kick clip brackets to line up with the cabinet feet and slide the clips on. Clip the toe kick into place onto the feet.

