

Assembly Instructions for cabinets: S60KU, S90KU

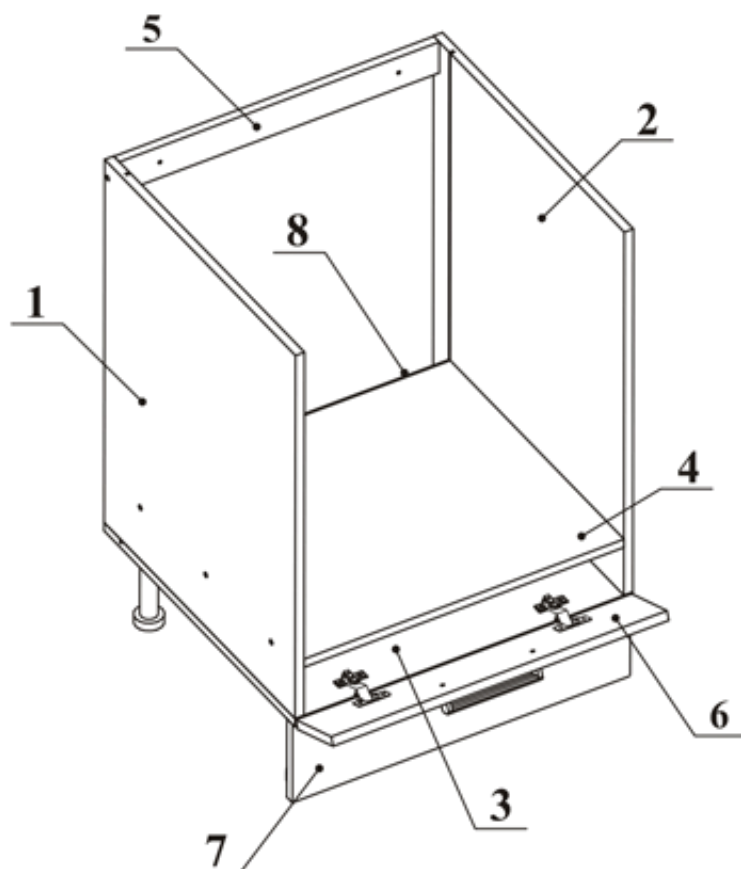

Check all the items are in your box according to the list on this manual. If you are missing anything, please check all other boxes first and then send us an email with a list of the parts you need.

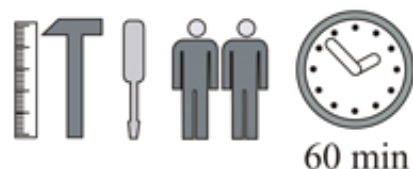
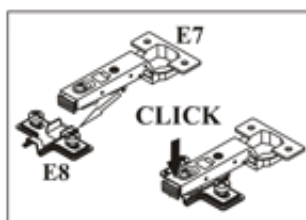
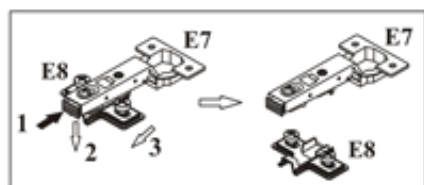

60 min

B11 X14 Ø7x50	G4 X14	E7 X2	E8 X2	I13 X4 L-150 mm	I14 X2
D10 X24 USØ3,5x13	A1 X6 Ø8x36	ZN X1	D26 X2 M4x22	G2 X1	B3 X5 Ø1,4x25
S1 X4					



S60KU, S90KU

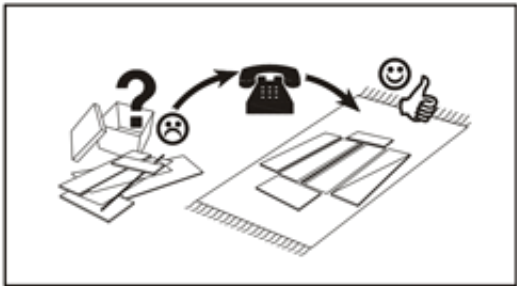

Check all the items are in your box according to the list on this manual. If you are missing anything, please check all other boxes first and then send us an email with a list of the parts you need.

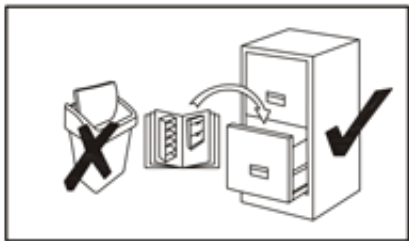

Keep your product assembly manual in a safe place until your kitchen is finished.

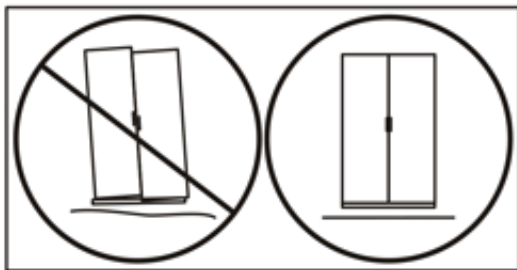

Be sure to assemble your cabinets on a flat surface and keep them straight and square.

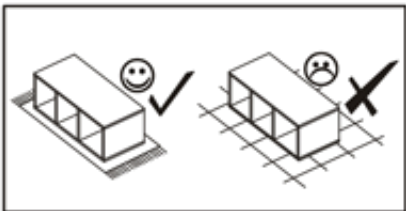
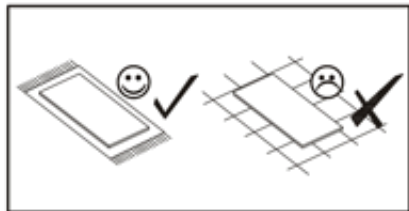

Assemble your cabinets on a rug or a surface that will not scratch or damage them.

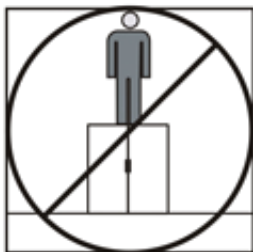
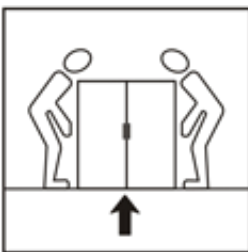

Do not push cabinets into place. Get someone to help you lift the cabinets into place, or you could risk damaging the feet.
Do not stand on the cabinets.

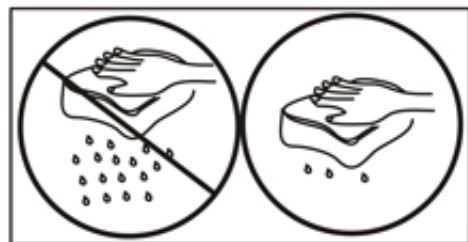

Once protective film on thermal wrap doors is removed, do not clean for 7 days. This allows the surface to harden. Only clean the cabinets with a small amount of warm water or non harsh chemicals.

S60KU, S90KU

1

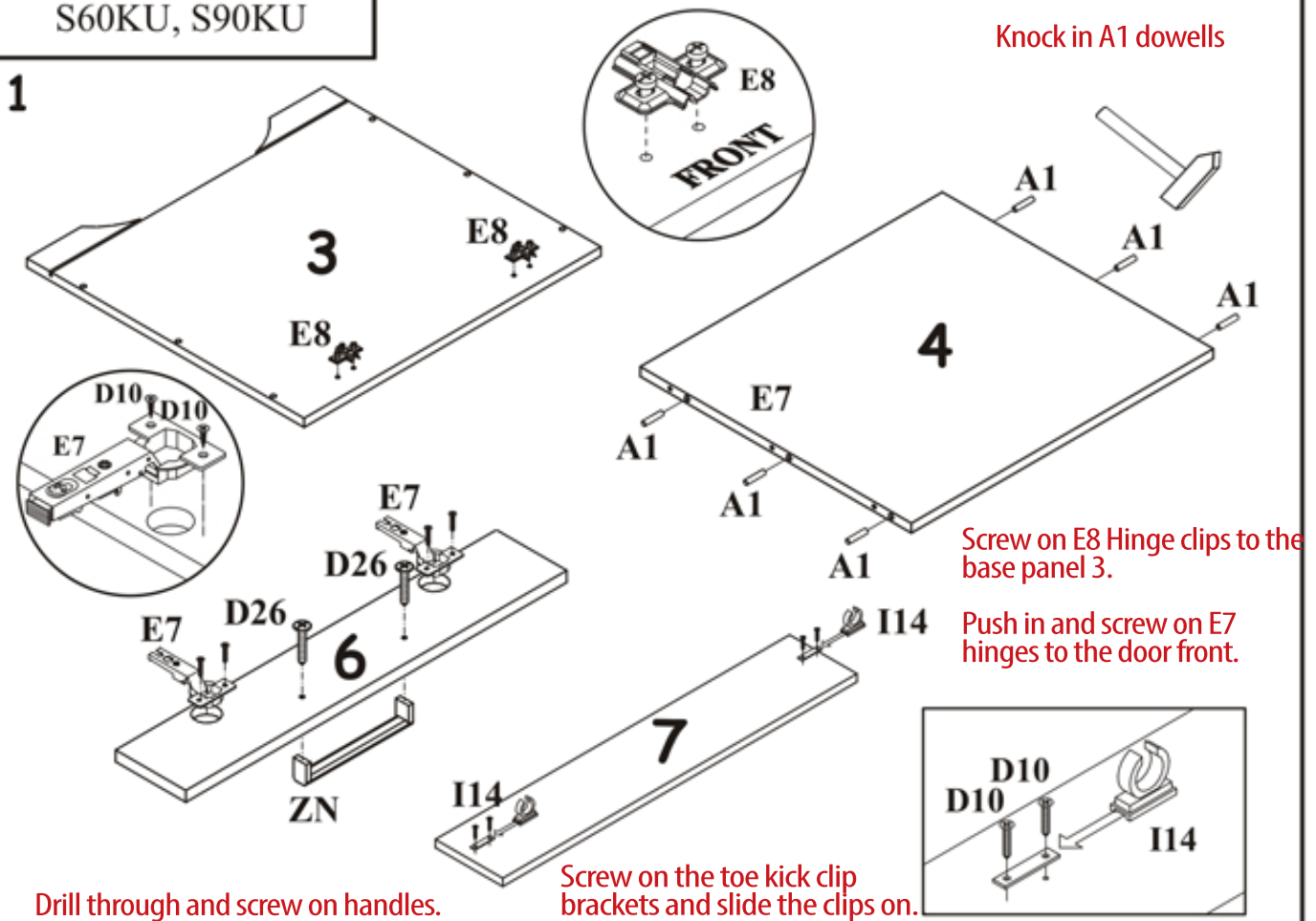

2

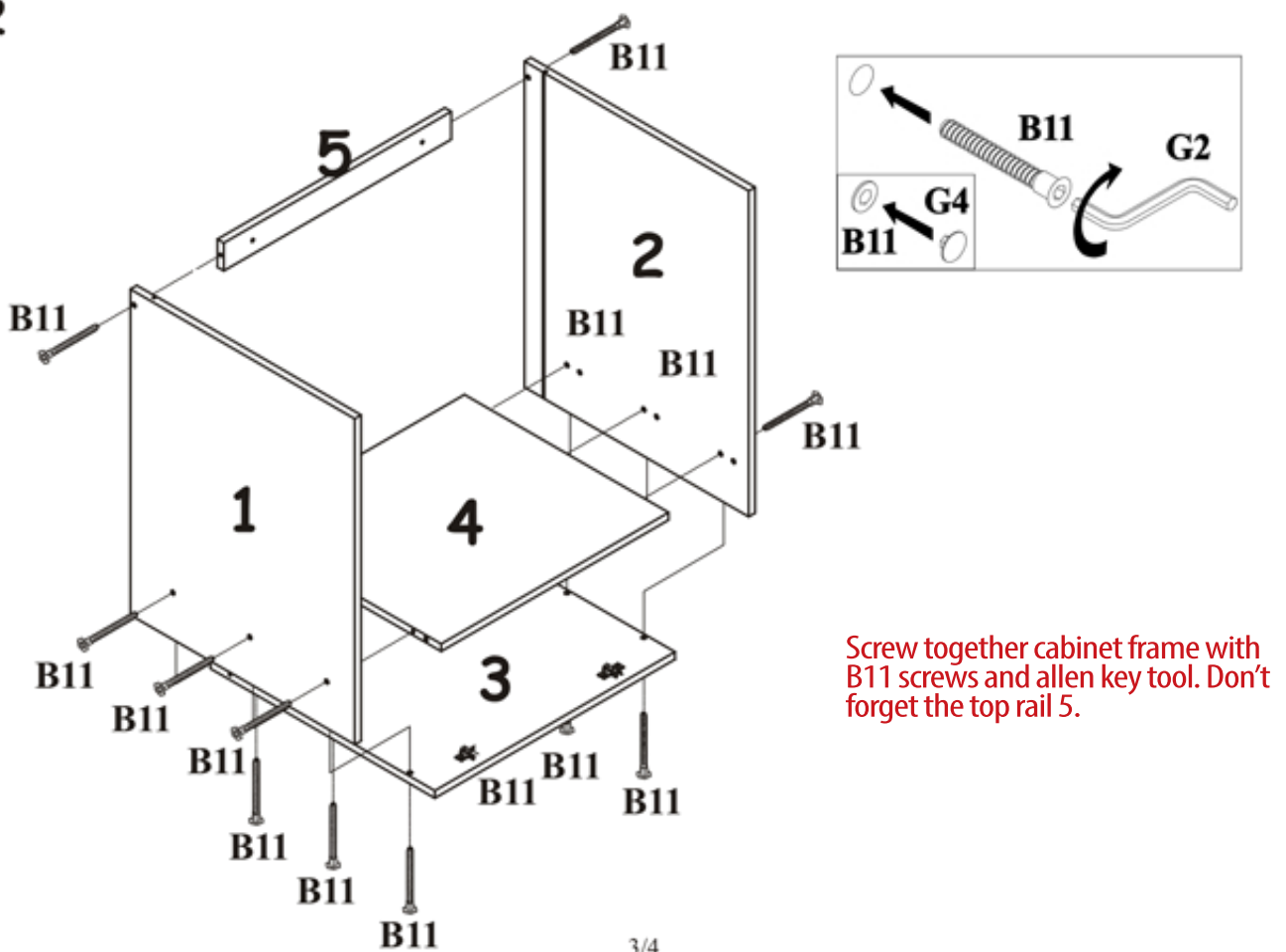

S60KU, S90KU

3

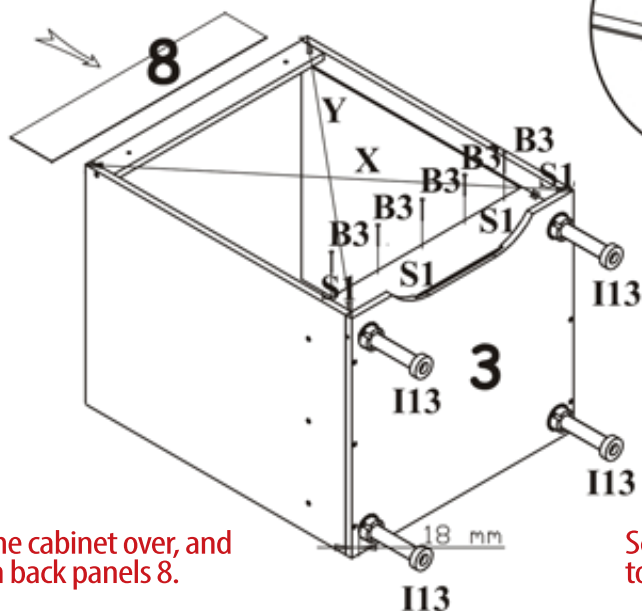

Turn the cabinet over, and nail on back panels 8.

Screw on adjustable feet to the base.

4

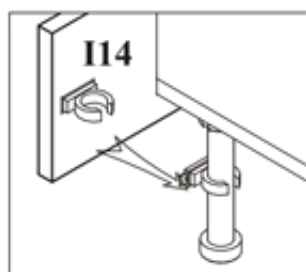
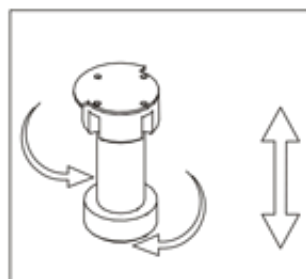
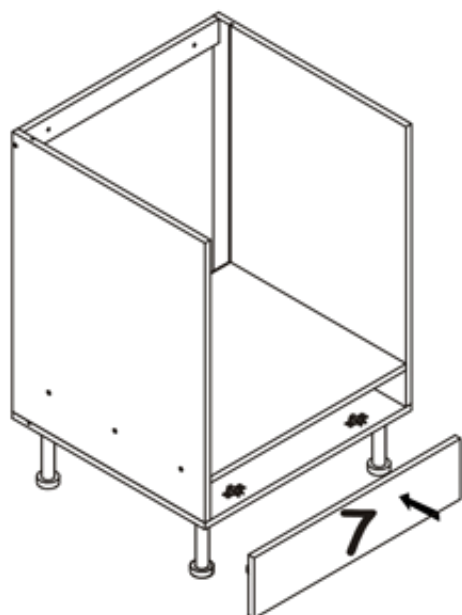

5

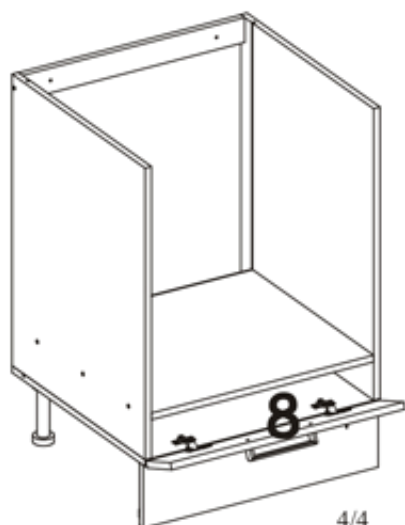

Adjust the feet to make the top of the cabinet level. Follow instructions for attaching the toe kick.

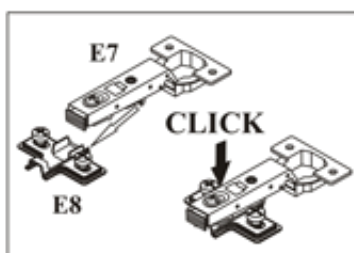

Attach the doors by clipping the hinges onto the hinge clips. Use a phillips head screwdriver to adjust the tilt and rotation of the doors to make them level.

