

Assembly Instructions for cabinets:
S30;S40;S50

B11 QUANTITY 10	 Ø7X50
-------------------------------------	--

Z2 QUANTITY 2	
-----------------------------------	---

G7 QUANTITY 4	
-----------------------------------	---

G4 QUANTITY 10	
------------------------------------	---

E1 QUANTITY 2	 H=0
-----------------------------------	--

I12 QUANTITY 4	
------------------------------------	---

E2 QUANTITY 2	 H=0
-----------------------------------	---

I14 QUANTITY 2	
------------------------------------	---

U12 QUANTITY 2	
------------------------------------	---

D10 QUANTITY 24	 Ø3,5x13
-------------------------------------	--

UP6 QUANTITY 6	 ØUP 4X30
------------------------------------	---

B3 QUANTITY S30-x21 S40-x23 S50-x25	 Ø1,4X25
--	--

G2 QUANTITY 1	
-----------------------------------	---

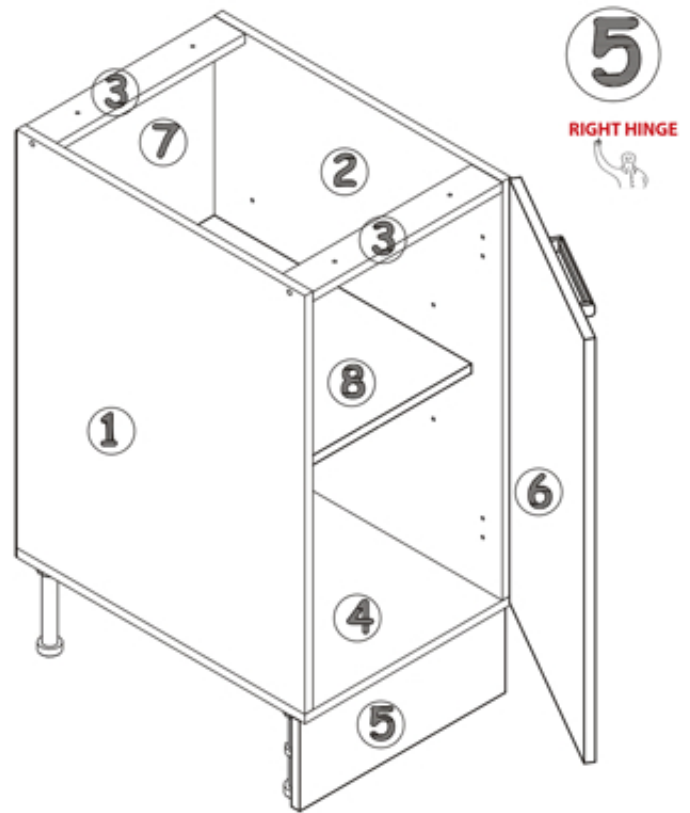

Check all the items are in your box according to the list on this manual. If you are missing anything, please check all other boxes first and then send us an email with a list of the parts you need.

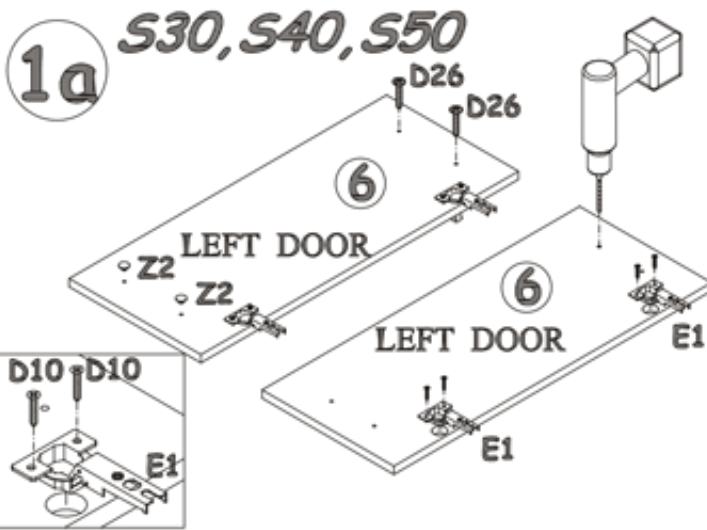

Drill through and attach handles with D26 screws. Push in Z2 caps to unused holes. Push E1 hinges into the holes on the doors on the side you wish to hinge them. Screw them in place straight with D10 screws.

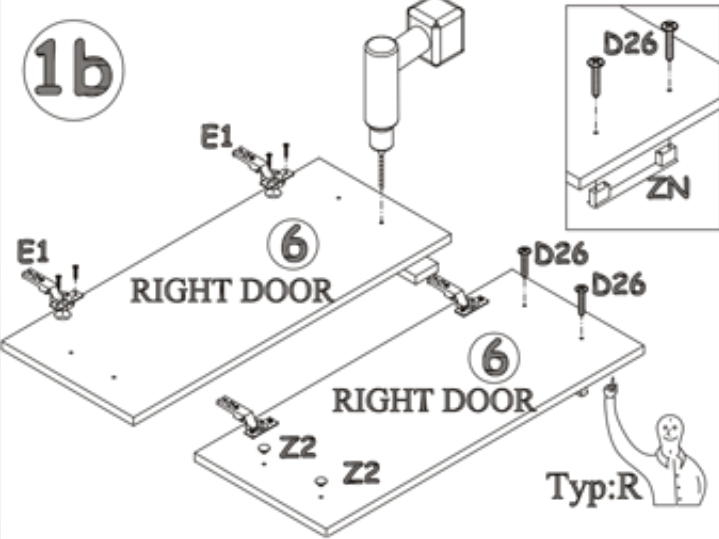

Drill through and attach handles with D26 screws. Push in Z2 caps to unused holes. Push E1 hinges into the holes on the doors on the side you wish to hinge them. Screw them in place straight with D10 screws.

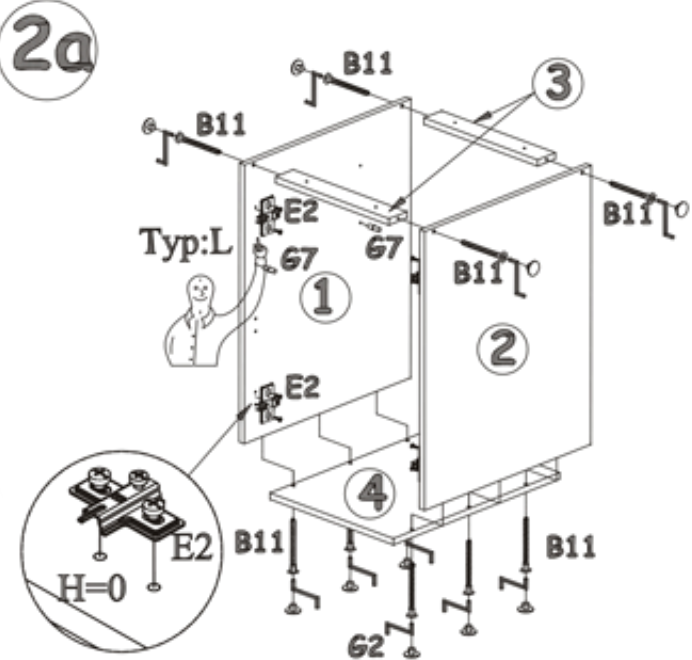

Screw together the cabinet frame, starting with the base and side panels, then the top rails. Use B11 screws and allen key tool. Screw the E2 hinge clips into the holes on the inside face of the side panel. Cover the screws with G4 screw caps.

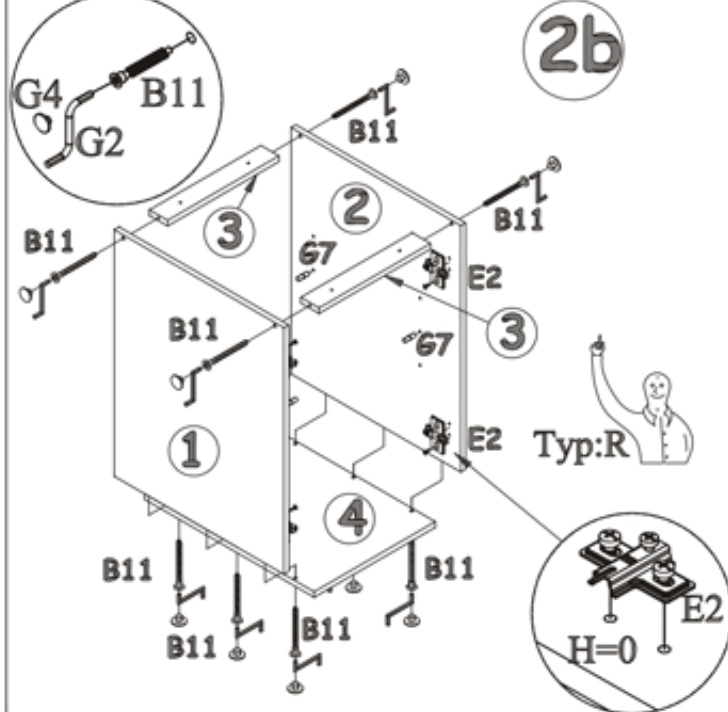

Screw together the cabinet frame, starting with the base and side panels, then the top rails. Use B11 screws and allen key tool. Screw the E2 hinge clips into the holes on the inside face of the side panel. Cover the screws with G4 screw caps.

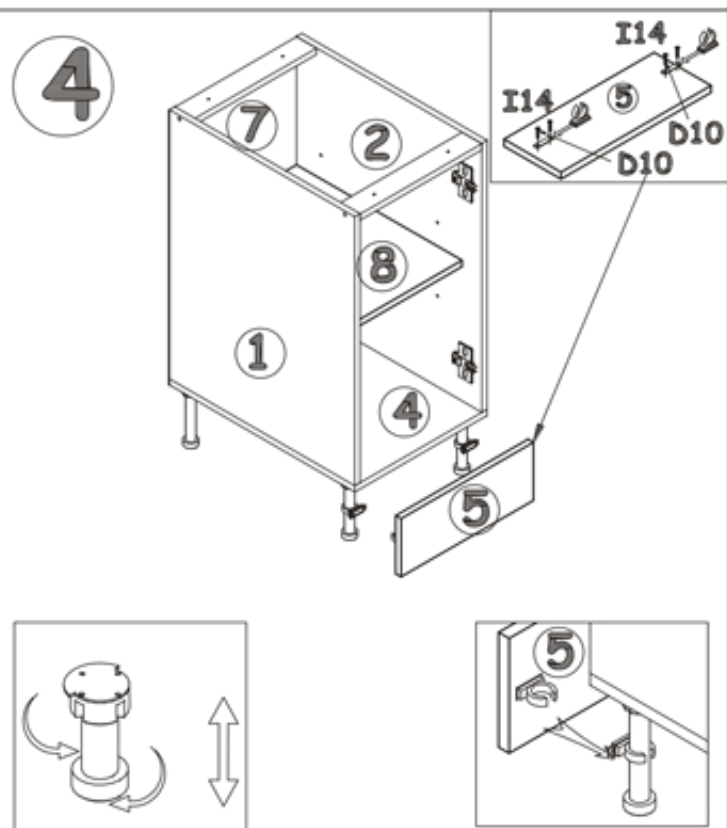
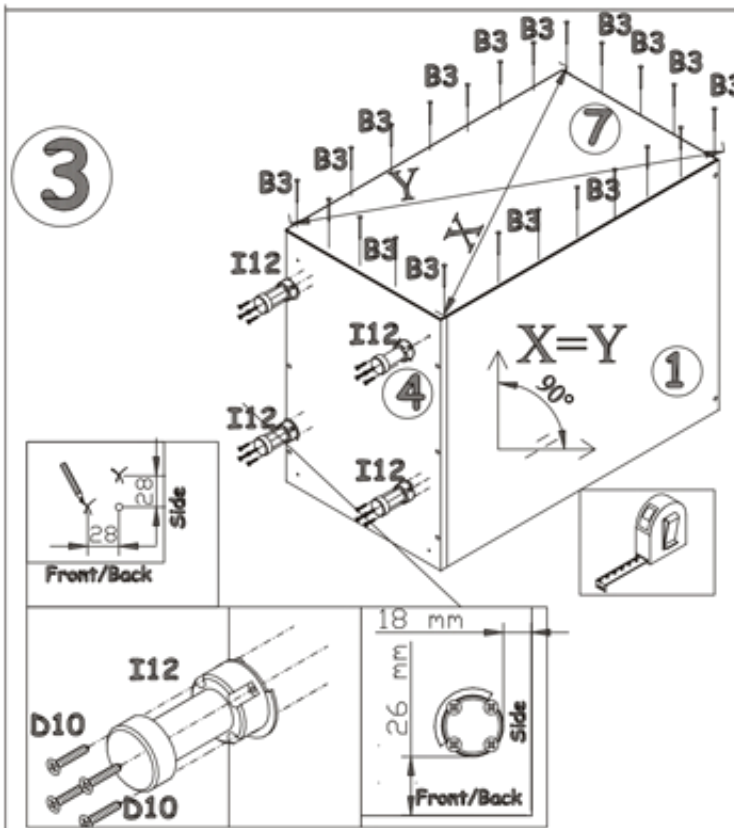

Carefully lay the cabinet on its front on a non scratch surface.
 Measure and screw the feet to the base.
 Nail on the back panel with B3 nails, making sure the panel is square with the back of the cabinet.

Twist the feet to adjust the height of the cabinet and make the top level.
 Follow additional instructions for fitting full length toe kicks.
 Screws the toe kick clips I14 onto the back of the toe kick and clip it onto the feet.

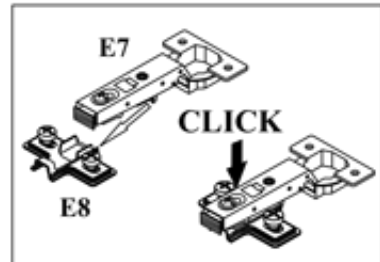
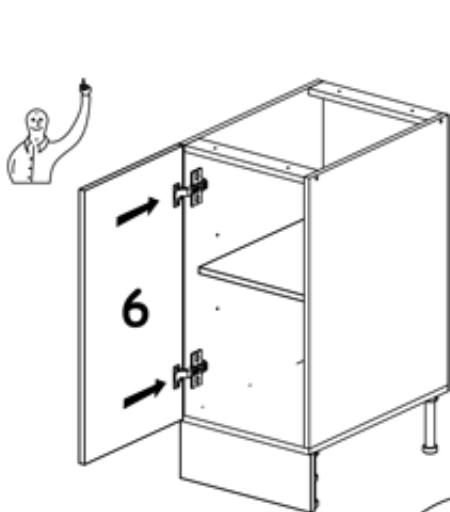

Attach the doors by sliding the E7 hinges over the E8 hinge clips and push down until it clicks into place. Adjust the tilt and rotation with a screwdriver.

