

# Assembly Instructions for cabinets: S15, S20, S30, S40, S50

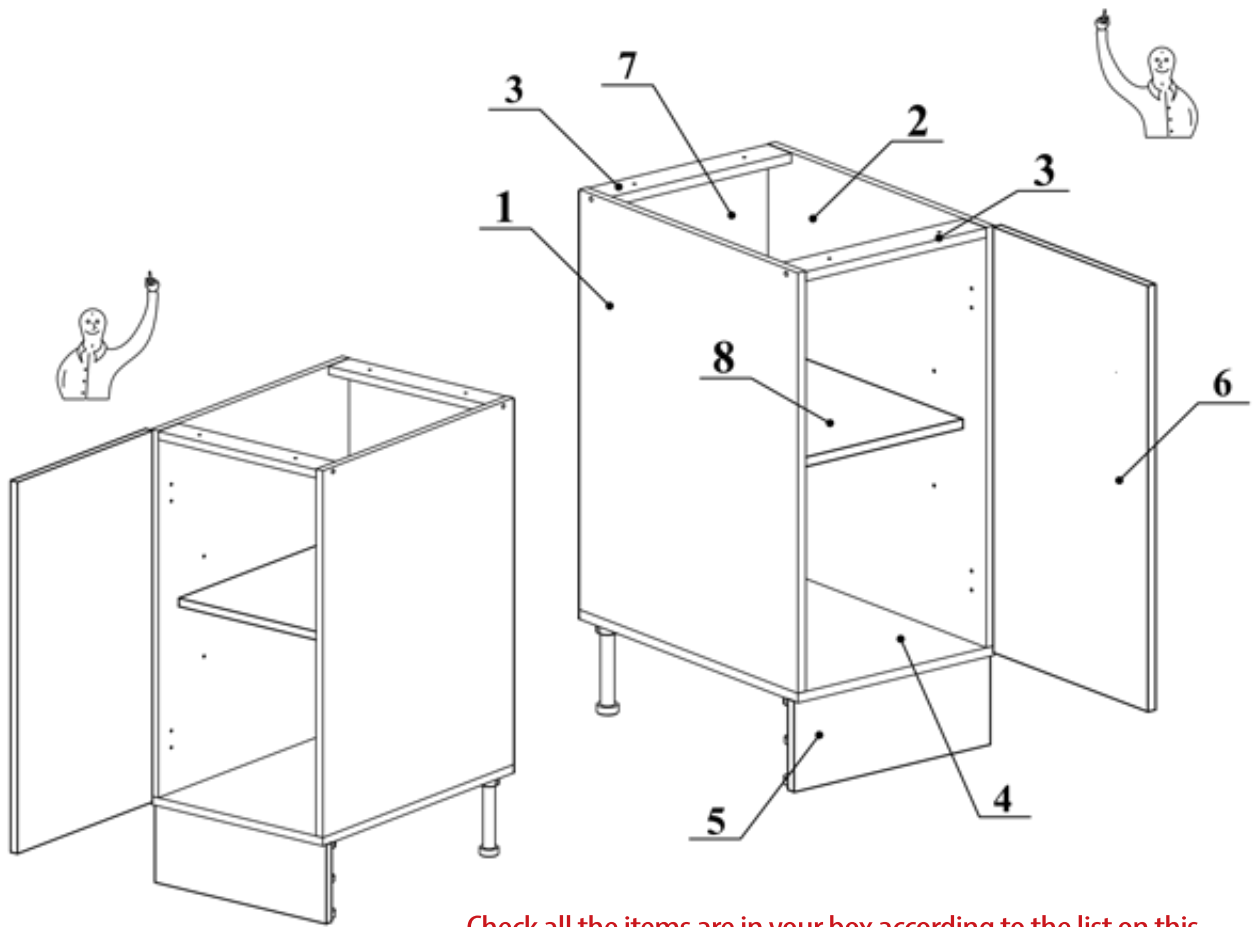

Check all the items are in your box according to the list on this manual. If you are missing anything, please check all other boxes first and then send us an email with a list of the parts you need.

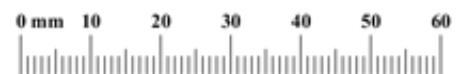
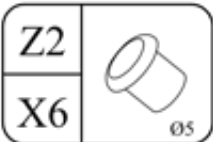
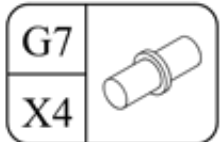
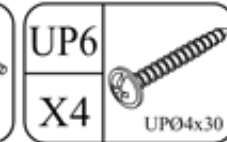
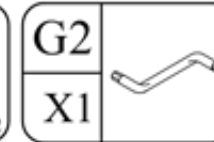
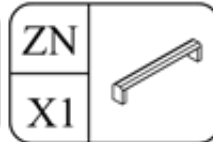
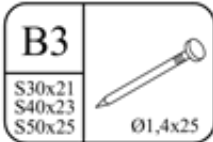
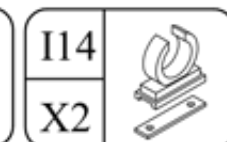
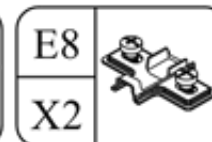
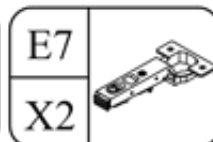
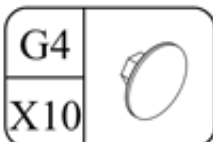
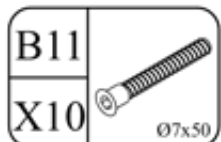
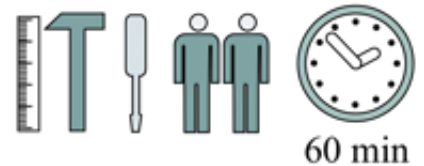
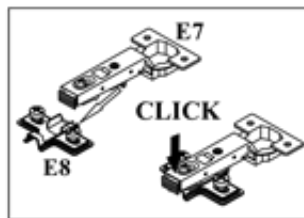
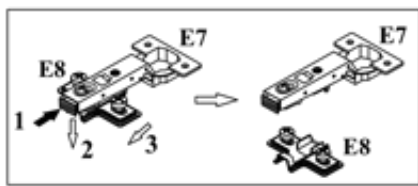

S15,S20,S30,S40,S50

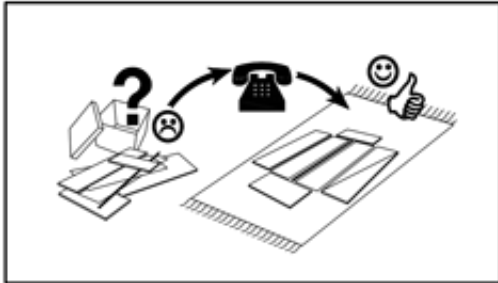

Check all the items are in your box according to the list on this manual. If you are missing anything, please check all other boxes first and then send us an email with a list of the parts you need.

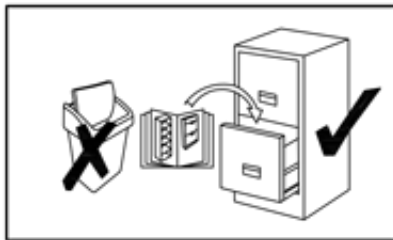

Keep your product assembly manual in a safe place until your kitchen is finished.

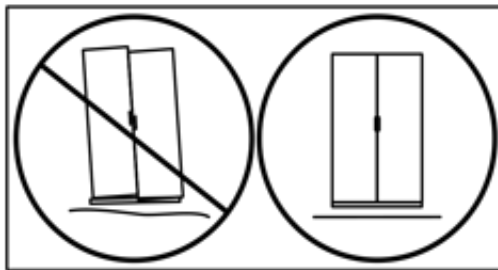

Be sure to assemble your cabinets on a flat surface and keep them straight and square.

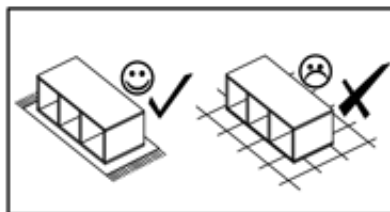
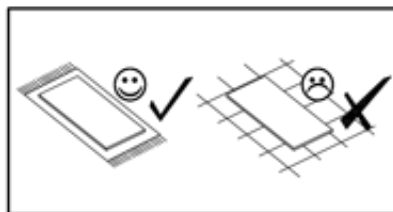

Assemble your cabinets on a rug or a surface that will not scratch or damage them.

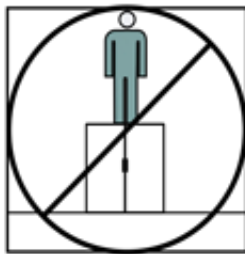
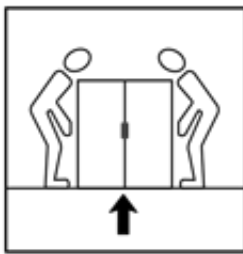

Do not push cabinets into place. Get someone to help you lift the cabinets into place, or you could risk damaging the feet.  
Do not stand on the cabinets.

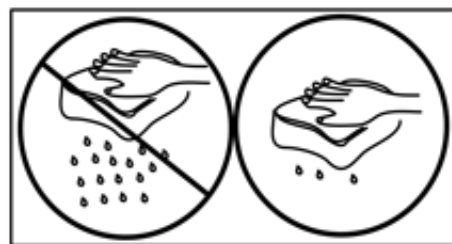

Once protective film on thermal wrap doors is removed, do not clean for 7 days. This allows the surface to harden. Only clean the cabinets with a small amount of warm water or non harsh chemicals.

S15,S20,S30,S40,S50

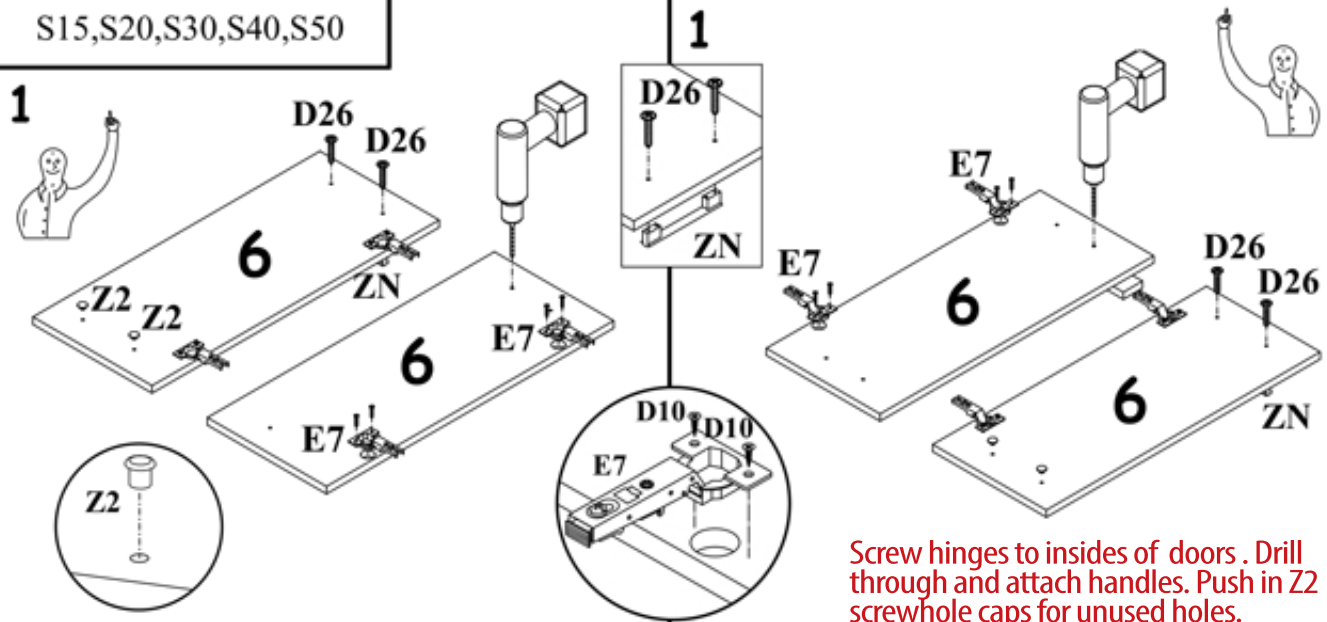

Screw hinges to insides of doors . Drill through and attach handles. Push in Z2 screw hole caps for unused holes.

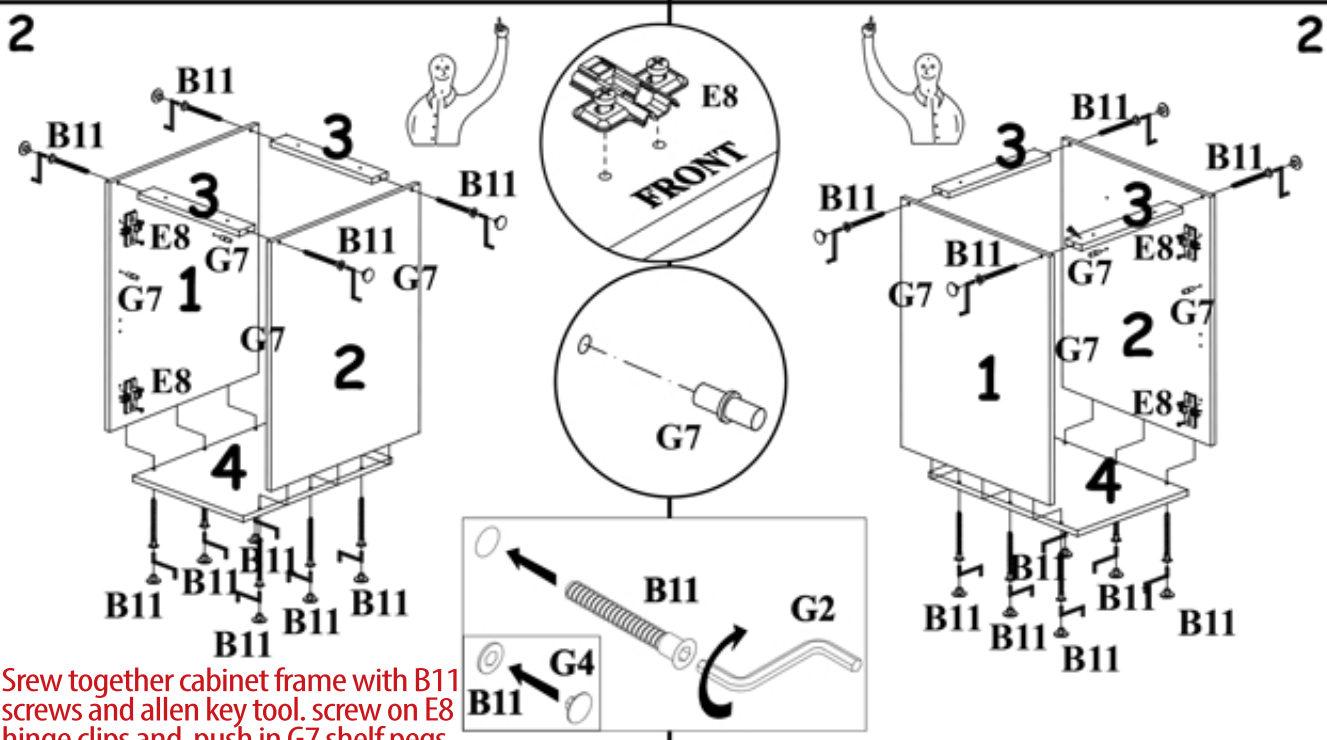

Srew together cabinet frame with B11 screws and allen key tool. screw on E8 hinge clips and push in G7 shelf pegs.

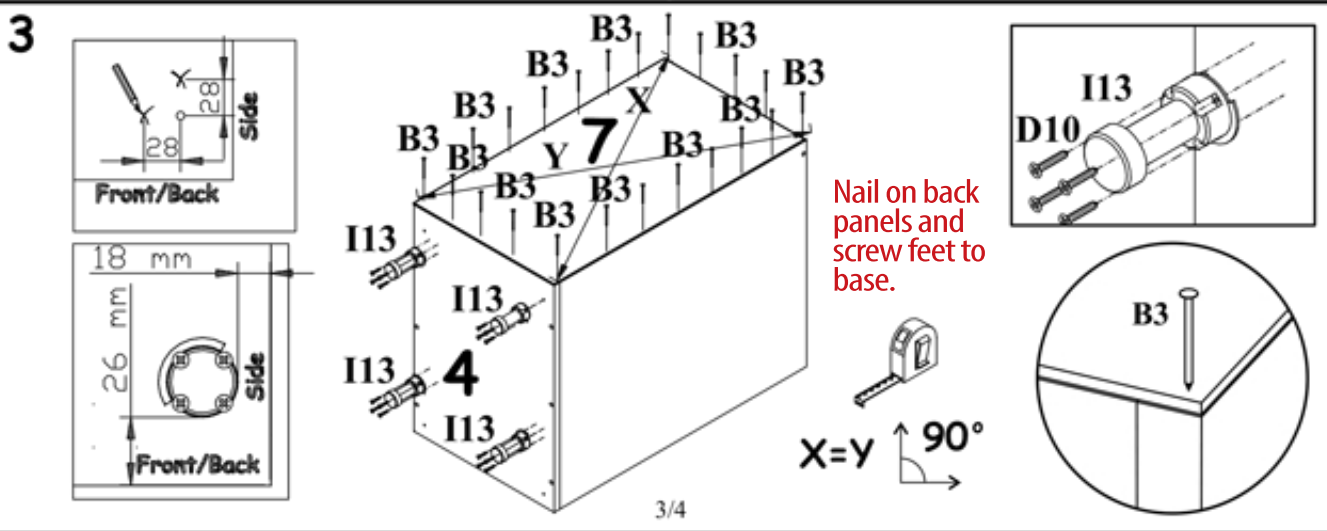

Nail on back panels and screw feet to base.

X=Y 90°

S15,S20,S30,S40,S50

4

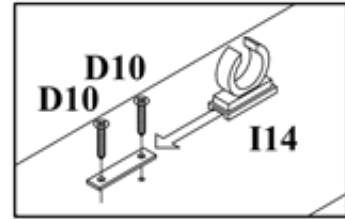
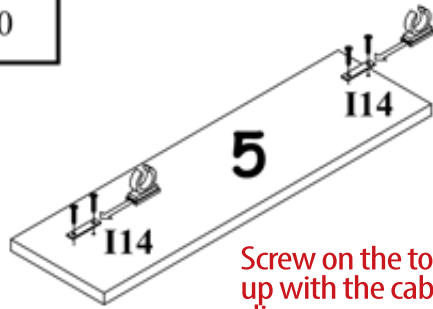

Screw on the toe kick clip brackets to line up with the cabinet feet and slide the clips on.

5

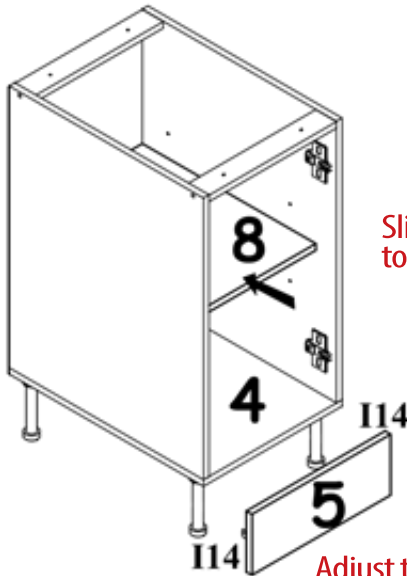

Slide in shelf on top of shelf pegs.

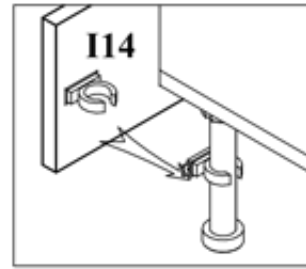
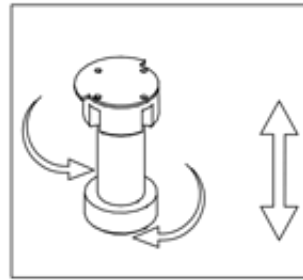

Adjust the feet to make the cabinet top level, then clip the toe kick into place.

6

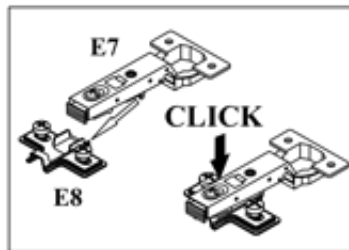
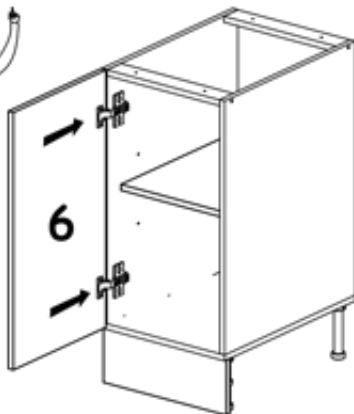

Attach the doors by clipping the hinges onto the hinge clips. Use a phillips head screwdriver to adjust the tilt and rotation of the doors to make them level.

